

CAM Express – 2½-Axis Machining

Benefits

- Easy to use
- Easy to deploy
- Low cost of ownership
- Work with any CAD data
- Postprocessor integrated and accessible to user

Features

- Single in-process workpiece between milling and turning
- Full tool library
- Machining data libraries
- Flexible operation navigator
- Shop documentation

Summary

CAM Express software is an in-depth, highly flexible system that allows users to maximize the value of their investments in the latest, most efficient and most capable machine tools. The 2½-Axis Machining package provides the basic milling and turning capabilities needed in the machinery industry, or for other 2½-axis applications such as finishing castings.

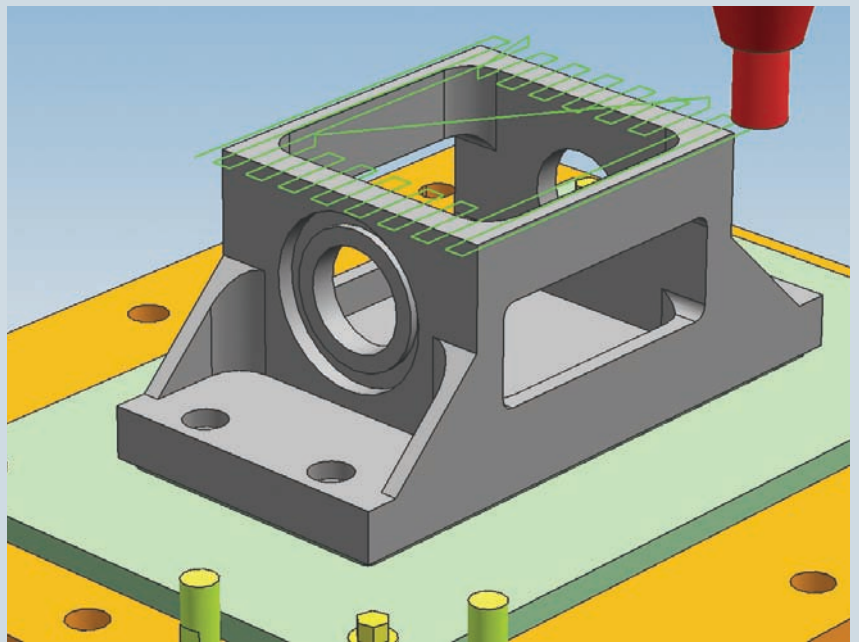

2½-axis milling

2½-axis roughing patterns can be applied based on basic boundary data or solid geometry. Zigzag, offset and plunge milling are examples of the toolpaths provided. High-speed roughing toolpaths such as trochoidal are available here. Feature-based machining functions automate the identification and programming of slots and faces.

VELOCITY SERIES

www.siemens.com/plm/camexpress

SIEMENS

CAM Express – 2½-Axis Machining

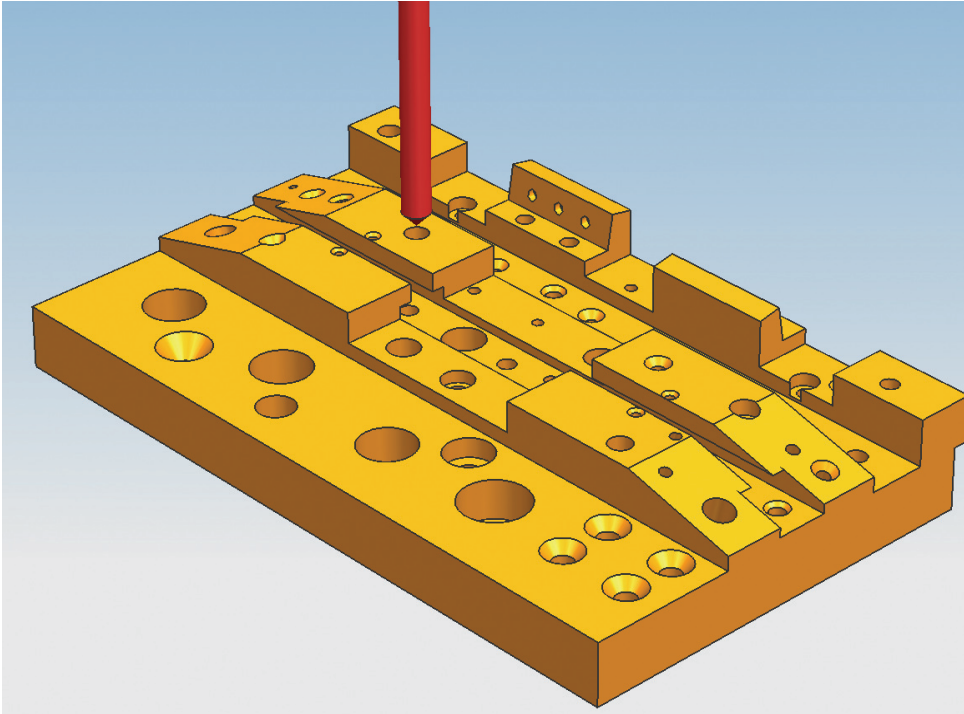

Drilling

CAM Express addresses drilling, reaming, boring, tapping, peck drilling and custom cycles. Automated hole making is available with the feature-based machining options.

Turning

CAM Express provides a complete solution that is easy enough to use on simple programs and capable enough to tackle your toughest geometry in multi-spindle, multi-turret applications.

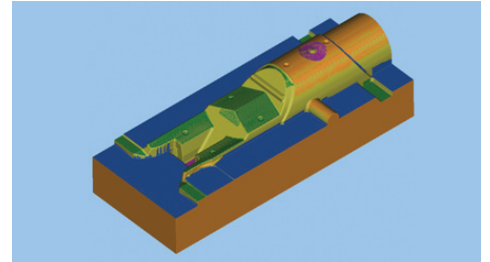
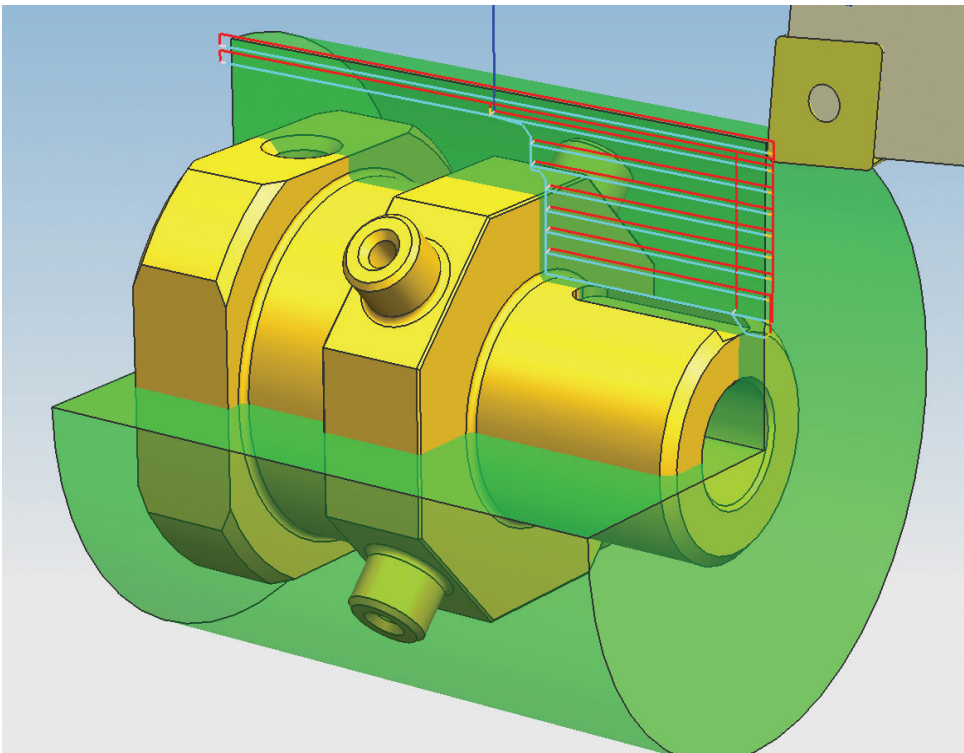

Comprehensive foundation –
CAM Express includes extensive support functions that add substantial value

Toolpath verification

Features dynamic pan and zoom during playback and visual display of material removal.

Geometry modeling and translation

CAM Express includes basic geometry creation and a collection of standard translators. Use the assembly modeling tools to assemble a detailed machine environment or to position parts and fixtures.

